

# Essential

## Charging Station

---

# Owner's Manual

Version F



[www.JAR-Systems.com](http://www.JAR-Systems.com) | 866.393.4202

# Essential Charging Station Owner's Manual Table of Contents

CS-1610, CS-1610-USBC, and CS-1210

- Before You Start: USB-C or AC? ..... 2
- Included with the Essential Charging Station ..... 2
- Main Components
- Hardware Packet
- Assembling the Station..... 3
- Prepare the Chassis
- Secure Chassis to a Wall or Desk (Optional)
- Install Power Strip (AC Station Only)
- Mount the Tray to the Chassis
- Install the Rubber Bumper
- Install the Top Security Bar (Optional)
- Insert the Dividers into the Tray
- Install Locking Arms (Optional)
- Cable Management (AC Station Only) ..... 6
- Warnings..... 7
- Disclaimer ..... 7
- Warranty ..... 7

Disclaimer: Failure to read, thoroughly understand, and follow all instructions can result in serious personal injury, damage to equipment, or voiding of factory warranty. It is the installer's responsibility to make sure all mounting systems are properly assembled and installed using the instructions provided. This information is the intellectual property of JAR Systems LLC and may not be distributed, duplicated or copied in part or full without the written permission. Since the use of this information, the equipment connected and the conditions by which any JAR Systems product is used is beyond the control of JAR Systems, it is the obligation of the owner and/or user to determine the correct and safe use of any equipment and product. To the extent that the law permits, any liability which may be incurred as a result of the use or future use of a product manufactured or sold by JAR Systems is limited to the cost of repairing or replacing the failed product or component at the discretion of JAR Systems either within, or outside of warranty periods, and does not extend to any loss or damage which may be caused as a consequence of misuse or failure of the equipment or product or the information contained herein. JAR Systems shall not in any event be liable for economic loss of profits, indirect, special, bodily injuries or consequential damages. Specifications and images are for illustration purposes only. Final product may differ and is subject to change without notice.

## Before You Start: USB-C or AC?



USB-C Charging Stations



AC Charging Stations

Essential Charging Stations are available as USB-C and AC configurations. Know which configuration you are assembling ahead of time. See the parts list below for reference. Skip sections that are labeled **(USB-C stations only)** or **(AC stations only)** if you are not assembling that configuration.

### Included:

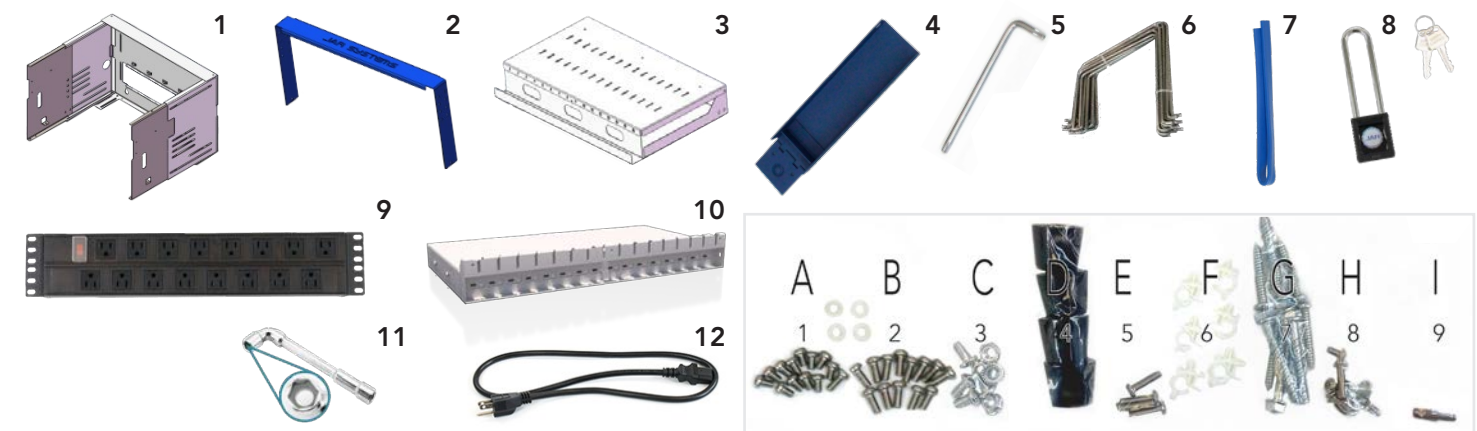

### Main Components

- 1. (1) Chassis
- 2. (1) Top Locking Bar
- 3. (1) Tray
- 4. (2) Front Locking Arms
- 5. (1) T25H Torx Key
- 6. Stainless Steel Dividers (11 for CS-1210, 15 for CS-1610)
- 7. (1) Chassis Rubber Bumper
- 8. (1) Padlock with (2) Keys
- 9. (1) Power Strip (AC stations only)
- 10. (1) Quick-Sense USB-C Hub (USB-C stations only)
- 11. Right Angle Box Wrench (USB-C stations only)
- 12. (1) Power Cable (USB-C stations only)

### Hardware Packet

- A1. (11) Short Screws and Washers
- B2. (8) Long Screws and Washers
- C3. (4) Power Strip Screws with Nuts
- D4. (4) Rubber Feet
- E5. (4) Screws for Rubber Feet
- F6. (4) Clear Cable Holder Clips
- G7. 3 Sets of (4) Wall Mounting Screws
- H8. Spare Hardware
- I9. Tools: Drill Bit

### Assembling the Station

#### Prepare the Chassis

- A. Remove contents of the carton and separate the major components. Use the T25H Torx key that is packaged with the manual to remove the security screw and washer from the center of the tray lid and set them aside to be replaced at the end of assembly. **(AC stations only)** Remove the contents from the tray.
- B. Extend the sides of the chassis out at right angles and tighten the pre-installed screws on corner of each side. Each side has one on the top and one on the bottom (4 screws total). **CS-1210 only:** The CS-1210 right panel is detached for shipping. Attach with 2 [B2] screws and washers.
- C. The supplied rubber feet [D4], [E5] can be optionally installed in the four holes on the bottom side of the station beside the holes used for securing the station to a horizontal surface.

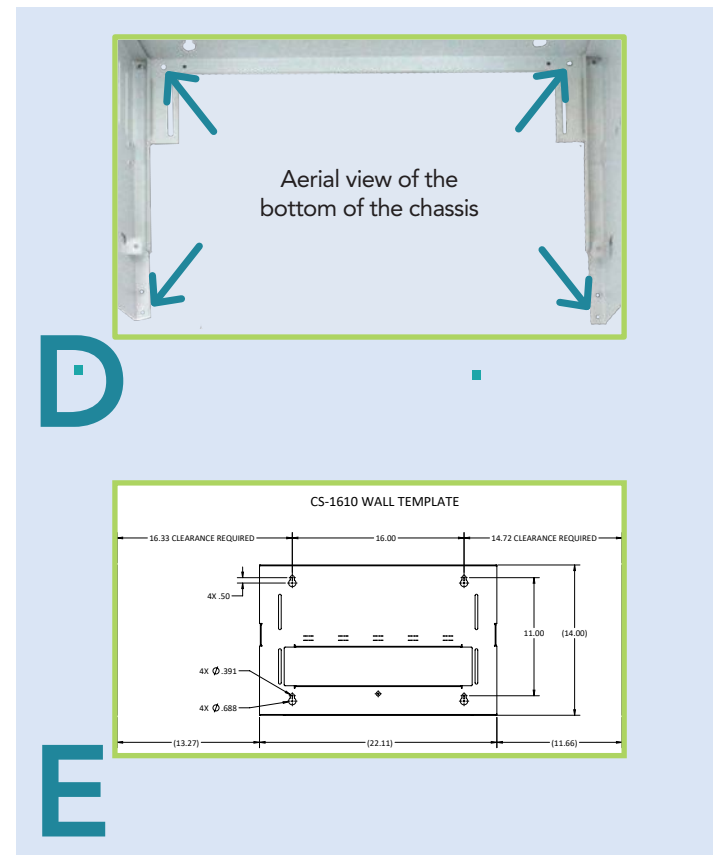
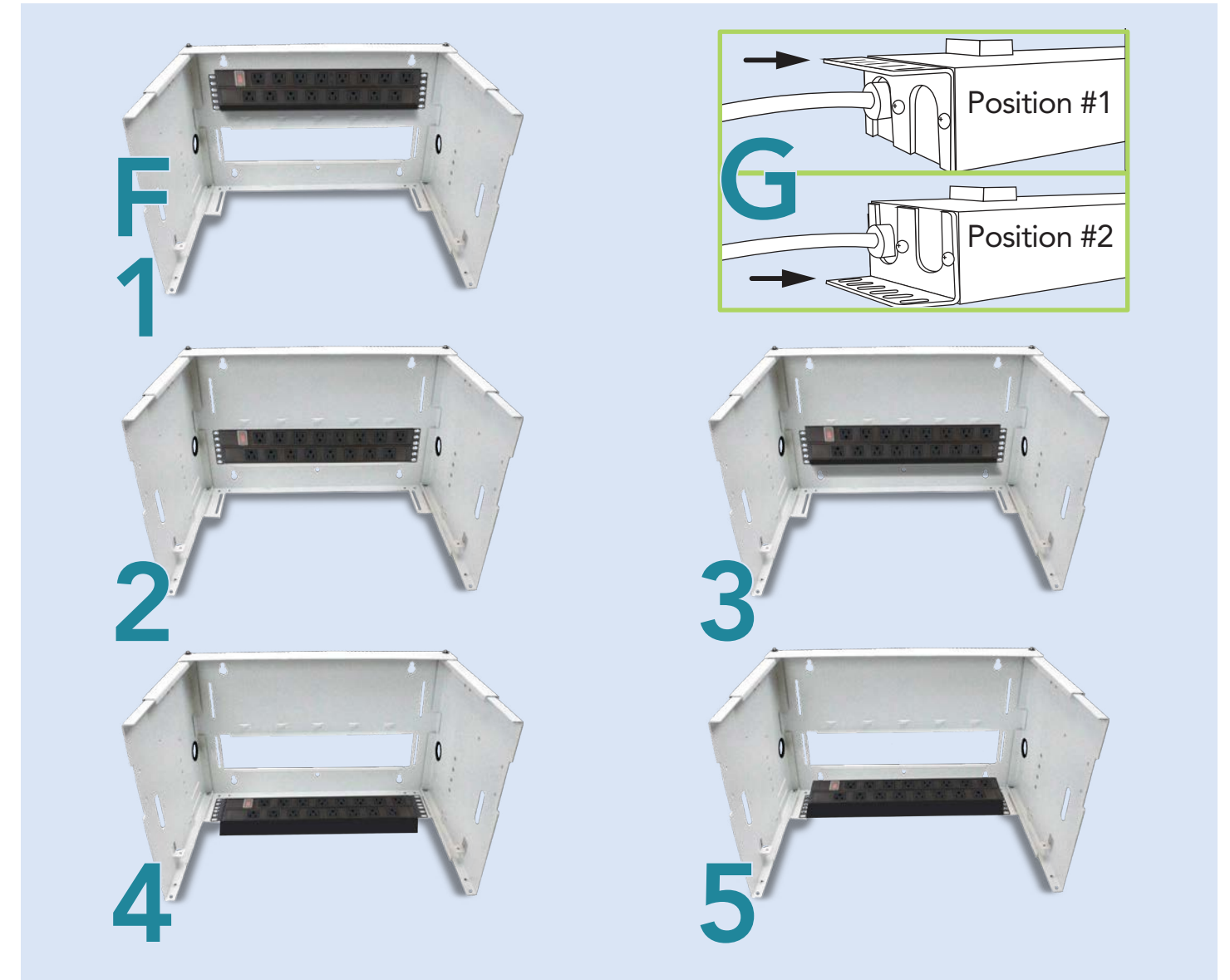
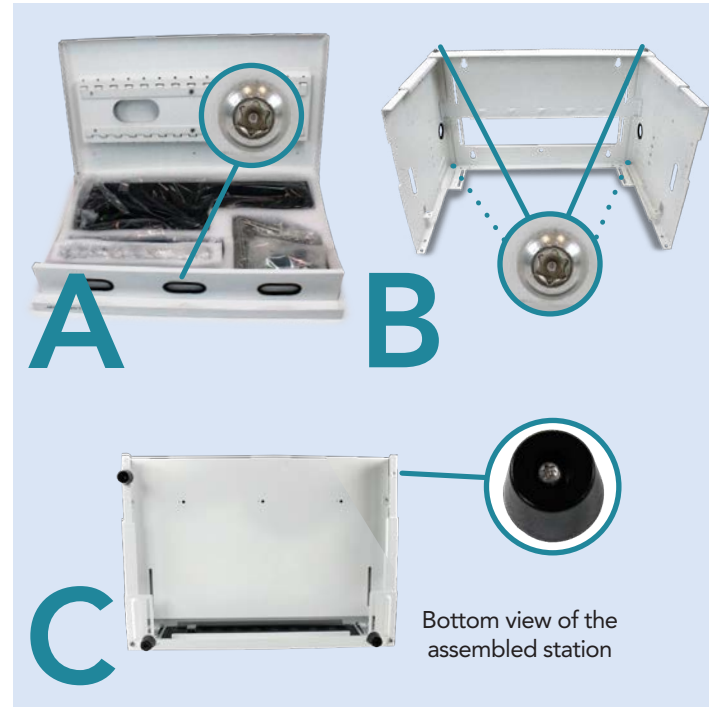

#### Secure Chassis to a Wall or Desk (Optional)

- D. If the station will be used on a table, desk, or countertop, it may be optionally secured to the surface by inserting 4 screws appropriate for the surface type through the bottom side of the chassis.
- E. To mount the station to a wall, use the supplied template as a guide for your screw location on the wall. Other tools helpful to mounting include a level, stud finder, and a pencil to mark mounting points over studs in the wall.

**WARNING:** Failure to provide adequate structural strength for this mounting system can result in serious personal injury or damage to equipment. It is the installer's responsibility to make sure the structure to which this mounting system is attached can support five times the combined weight of all equipment. Reinforce the structure as required before installing. The wall to which the mount is being attached may have a maximum drywall thickness of 5/8" (1.6cm). Always ensure that proper hardware is used for the wall surface type. Never operate this mounting system if it is damaged. Contact JAR Systems for replacement or repair.

#### Install the Power Strip (AC stations only)

- F. Install the power strip in one of the following positions with [C3] 4 screws and nuts.
  1. Recommended for smaller devices.
  2. Recommended for most desktop usage.
  3. Alternate position for desktop usage.
  4. Recommended for most wall-mount usage.
  5. Alternate position for wall-mount usage.

- G. If necessary, the power strip can be mounted on either the front (position #1) or back (position #2) by reversing the mounting brackets. Loosen the three screws on each side, rotate the bracket, and replace the screws.



**Mount the Tray to the Chassis**

H. Pull out the sides of the chassis to the depth needed for your device. If the sides will not slide out easily, loosen the pre-installed screws on the sides. Note: To prevent unauthorized removal of devices, do not extend the sides further than needed to fit the devices.

I. Rest the tray on the tabs near the front of the chassis. Insert 3 [B2] screws with plastic washers through the chassis and into the tray on each side of the station.

**Install Rubber Bumper (Optional)**

J. To protect your devices from hitting the back edge of the chassis, utilize the supplied rubber bumper.



**Install the Top Security Bar (Optional)**

K. For security, place the top locking bar at the lowest height that will fit over the devices. Use 2 [B2] screws on the top two holes on the outside. Open the tray lid and prop it up by placing a security screw or the Torx wrench in the side of the station. Install 1 [A1] screw from the inside of the chassis to prevent removal, on both sides.

and re-install the divider locks beneath the shelf using 6 [A1] screws.

**Install the Front Locking Arms (Optional)**

M. For security, install the front locking arms using 2 [A1] screws on each side. Screws for the locking arms should be installed from the inside of the chassis to prevent removal.

**Insert the Dividers into the Tray**

L. Remove the pre-installed divider locks from under the shelf. Insert the dividers into the slots on the shelf. Ensure that all dividers are properly seated

N. Use the included padlock to secure the station by looping it through the holes in the arms. Using the padlock in the "upside down" position may be easier for some users. **This step completes the setup for USB-C configurations.**



**Cable Management (AC stations only)**

O. Open the tray lid and prop it up by placing a security screw or the Torx wrench in the side of the station.

P. Determine the length of cable that is needed to reach from the tray to the devices.

Q. Determine the best method of arranging the cables that come with your device.

AC ADAPTERS FRONT TO BACK: Best for some wider adapters.

AC ADAPTERS LEFT TO RIGHT: Best for some narrower adapters.



TABLET (NO AC ADAPTER): Use provided clips [F6] beneath shelf to secure cables in groups of 5-6.

*TIP: Adapters can often be installed as they come bundled in the box. If the cables are not bundled at all, twist ties or Velcro ties are helpful. If the devices have larger AC adapters (5"x 2"x 1.25" or larger) the adapters will fit snugly in the tray. In this case it may be best to arrange most of the adapters as far back in the tray as possible from left to right, flipping about half on their side. Contact JAR Systems for additional assistance.*

R. After AC adapters are arranged in the tray, plug them into the power strip. For best results, bundle any excess cable length if it is not already.

S. (OPTIONAL) Secure the tray lid shut using the security screw and washer that were removed in step A and the Torx key to prevent adapters from being removed or tampered with. **This step completes the setup for AC configurations.**

Want to skip this cable management process? CS-1610 and CS-1210 AC charging stations can be upgraded to Quick-Sense USB-C charging. Contact JAR Systems for more information: 866.393.4202 JAR-Systems.com

## Warnings

Exceeding the weight capacity can result in serious personal injury or damage to equipment. It is the installer's responsibility to make sure the combined weight of all components attached to this mount does not exceed 100 lbs.

If the station is being used or transported on an AV cart or charging cart, the station must be secured down to the cart.

Power down all devices prior to connecting them to the Quick-Sense USB-C Hub for charging.

Keep away from moisture and harsh chemicals. Do not place any liquids near the station.

Any electrical equipment must be used by an adult or with adult supervision.

Do not connect unsupported items to the charging station or use for any purpose other than intended.

Do not attempt to obstruct any ventilation openings or dismantle, open, or modify the system in any way.

Do not sit or stand on the station or Quick-Sense USB-C Hub.

Do not use an extension cable or daisy-chain to any other devices.

The Quick-Sense USB-C Hub is not intended for operation at altitudes greater than 2000 m or 6561 ft above sea level and should not be operated in extreme temperatures. For indoor use only.

## Disclaimer

Failure to read, thoroughly understand, and follow all instructions can result in serious personal injury, damage to equipment, or voiding of factory warranty. Since the use of this information, the equipment connected, and the conditions by which any JAR Systems product is used is beyond the control of JAR Systems, it is the obligation of the owner and/or user to determine the correct and safe use of any equipment and product. To the extent that the law permits, any liability which may be incurred as a result of the use or future use of a product manufactured or sold by JAR Systems is limited to the cost of repairing or replacing the failed product or component at the discretion of JAR Systems either within, or outside of warranty periods, and does not extend to any loss

or damage which may be caused as a consequence of misuse or failure of the equipment, product or the information contained herein. JAR Systems shall not in any event be liable for economic loss of profits, indirect, special, bodily injuries or consequential damages. Specifications and images are for illustration purposes only. Final product may differ and is subject to change without notice.

## Warranty

This product comes with a warranty that covers any defects in material or workmanship and extends to the original consumer of the product only. JAR Systems, LLC will replace the product with a new or refurbished product, repair the product, send replacement parts, or refund the purchase price of the product, at JAR Systems, LLC's discretion. This warranty does not cover accidental damage, unreasonable use, neglect, tampering or other causes not arising from defects in material or workmanship.

Any implied warranties last only as long as the warranty periods listed above except where state law does not allow limitations on how long an implied warranty lasts. This includes but is not limited to the implied warranties or merchantability and fitness. JAR Systems, LLC's responsibility is limited to the actions listed above and nothing else.

This warranty does not cover, and JAR Systems, LLC will not be responsible for, any damages due to loss of use of the product, or any other costs or expenses incurred by you or anyone else who uses the product, whether due to defects, breach of contract, negligence, strict liability or otherwise. JAR Systems is not liable for any indirect, special, incidental or consequential damages related to the product or this warranty. Some states do not allow exclusions or limitations on consequential or incidental damages, so these limitations or exclusions may not apply.

This warranty gives you specific legal rights and you may also have other rights that vary from state to state. This warranty is governed by the laws of Florida, excluding its conflict of laws principles, unless your state requires that its law be used.

Contact JAR Systems for information on the length of warranty on your product(s).